

OPERATION

PRODUCTS SAFE TO USE

- Water + Liquid Concentrate
- Water + Powder Concentrate
- Alcohol
- Filtered Fruit-Based Product

PREPARING THE PRODUCT

Product will need to be premixed before adding it into the machine. Follow the manufacturer's recommendations for mixing.

Assemble Air Filter: Locate the filter in the machine's packaging. Insert it into the groove at the bottom of the chassis, at the front. Slide it completely until it stops. (Fig. 1)

FILLING THE BOWL

Open the Lid: Lift the front part. (Fig. 2)

Filling the Bowl: Do not use liquids with temperatures over 25°C/77°F.

Filling Level: MAX up to sticker; MIN cover the evaporator. (Fig. 3)

Close the Lid: Lower the front part.

PREPARING COLD DRINKS

Startup: With the machine plugged into the power source, push the main switch. (Fig. 4)

Slush: Press **OPERATING MODE BUTTON** until the display shows **SLUSH**. (Fig. 5)

Note: In order to obtain a slush consistency, the mixture must have a minimum sugar content of 13° BRIX (13g sugar to 100g solution). A lower concentration may damage the spiral blades and gear motors.

Cold Drink: Press **OPERATING MODE BUTTON** until the display shows **STANDBY**. (Fig. 6)

During Preparation, We Can See:

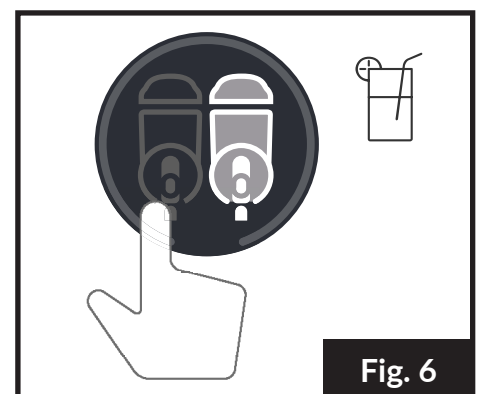
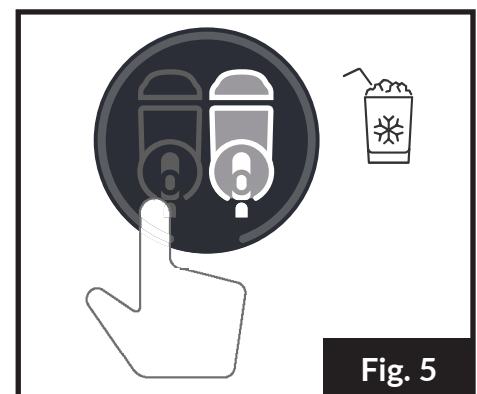
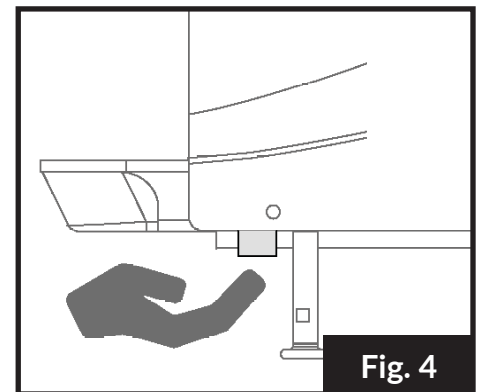
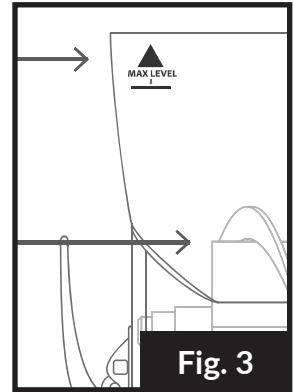
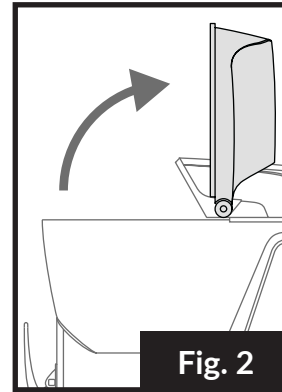
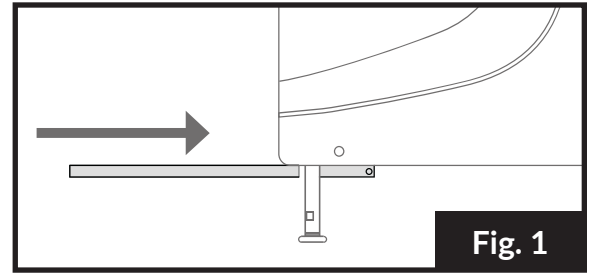
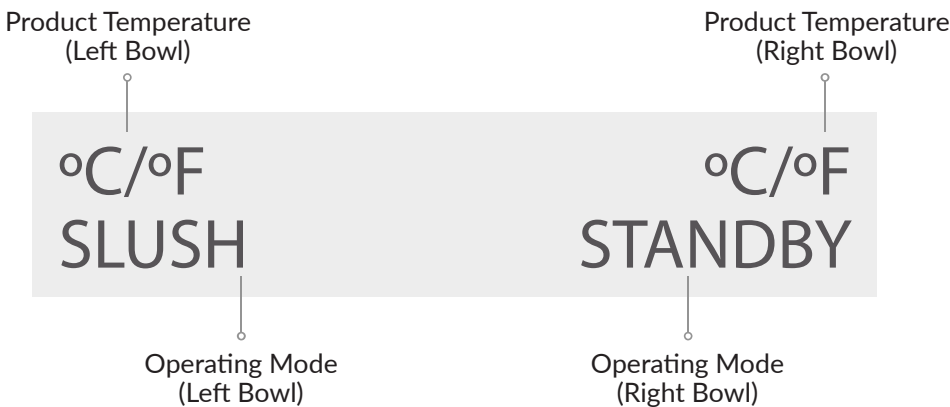

OPERATION

SERVING THE PRODUCT

The push and pull tap allows us to serve the product in two different ways:

Pull: Pull the handle. (Fig. 7)

Push: Push the handle. (Fig. 8)

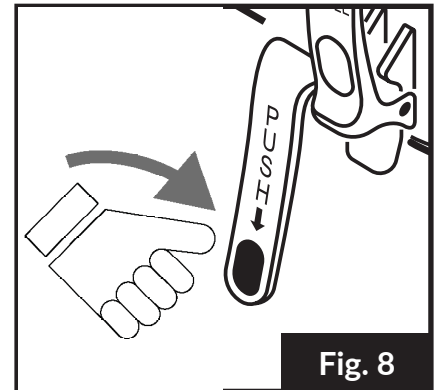
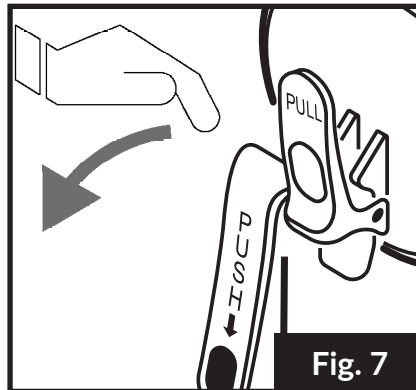

IF ICE CRYSTALS APPEAR

Select Defrost Mode: Press **OPERATING MODE** until the display shows **DEFROST**. (Fig. 9)

This allows you to defrost the product quickly. Wait until Defrost finishes. (During Defrost, Slush and Standby mode of any tank is deactivated.)

Prepare Slush: Press **OPERATING MODE** until the display shows **SLUSH**. (Fig. 10)
In this way, the slush always remains homogeneous and prevents the formation of excessively large ice crystals.

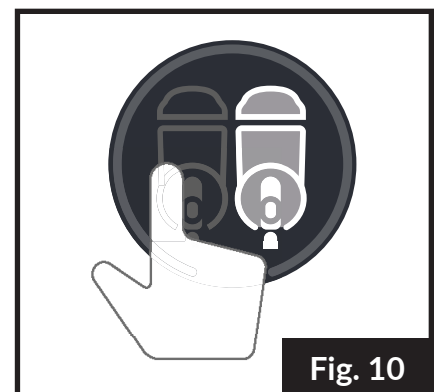
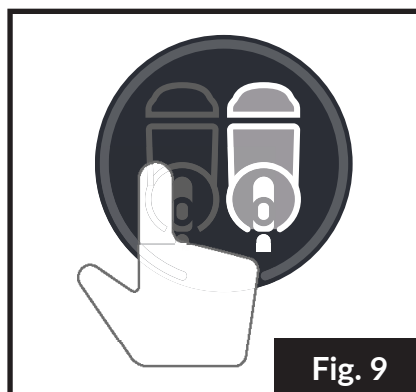

AFTER HOURS (STANDBY MODE)

Select Standby Mode: Press **OPERATING MODE** until the display shows **STANDBY**. (Fig. 11)

During the periods when the establishment is closed, it is possible to use the machine in Standby mode. Doing this will allow you to save a considerable amount of electrical energy.

